

FACING THE
ANGOLAN AMBASSY

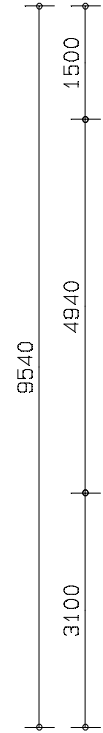

FACING THE TAXI RANK TOWARDS SHALI GARAGE

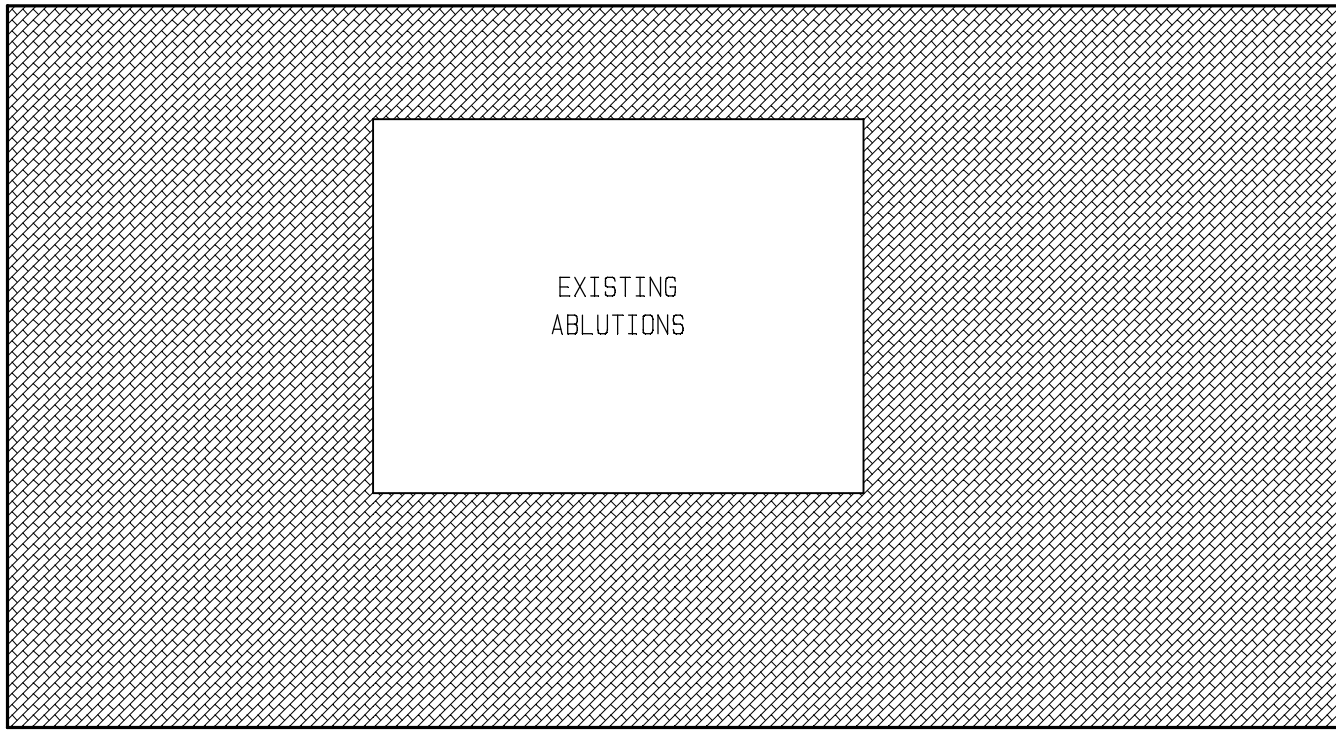
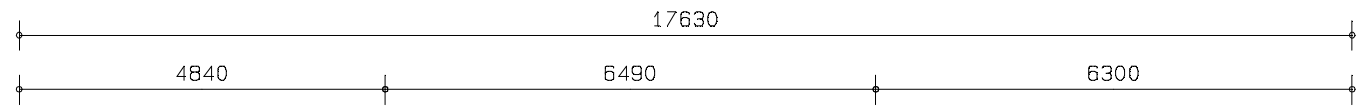

EXISTING
ABLUTIONS

FACING THE MAIN ROAD

NEW AREA TO BE INTERLOCKED 137,00m

FACING THE PARK

REV	DATE	DESCRIPTION	BY	CHK
Client:				
NEW INTERLOCKS FOR OSHAKATI TOWN COUNCIL ANGOLA EMBASSY PARK OSHAKATI WEST				
ENGINEERING DONE BY:				
OSHAKATI TOWN COUNCIL P/BAG 5333 - OSHAKATI SAM NLUOMA DRIVE				
PROJECT:				
TITLE: INTERLOCK LAYOUT				
SCALE 1:100/200		SHEET SIZE: A4		
DRAWING NO.	PAN - AG - 5337 - 303	REV		
SHEET	1	OF	1	D



This document was created with the Win2PDF “print to PDF” printer available at <http://www.win2pdf.com>

This version of Win2PDF 10 is for evaluation and non-commercial use only.

This page will not be added after purchasing Win2PDF.

<http://www.win2pdf.com/purchase/>